



# FISCHER FREEDOM™ SERIES FISCHER LP360™ CONNECTORS

**EASY MATING**  
**FULLY CLEANABLE**  
**LOW PROFILE**

**4-7** CONTACTS

- No key code, 360° mating freedom
- Blind-mate, non-magnetic quick-release locking
- Fully cleanable, plug and receptacle
- Easy integration, MOLLE compatible
- IP68 sealed to 20m/24h



**PLUG & USE**



REIMAGINING CONNECTIVITY  
TOGETHER

**fischer**<sup>®</sup>  
CONNECTORS

# AVAILABLE SIZES 1:1\*

# BODY STYLES

**08** (4 contacts)



**14** (7 contacts)



**14** (7 contacts)



\*Actual size 1:1 when printed at full size on A4 paper.

## PLUGS

### CABLE MOUNTED

BODY STYLE	FLP01	FLP01
Locking system	Quick-release	Quick-release
Sealing	IP67	IP68
Size	8	14
Contact	4	7
Housing material	Plastic	Metal

### PANEL FRONT MOUNTED

BODY STYLE	FLP03	FLP03
Locking system	Quick-release	Quick-release
Sealing	IP68	IP68
Size	08	14
Contact	4	7
Housing material	Metal	Metal

## RECEPTACLES

### CABLE MOUNTED

BODY STYLE	FLR50
Sealing	IP68
Size	14
Contact	7
Housing material	Metal

### PANEL REAR MOUNTED

BODY STYLE	FLR01	FLR01
Sealing	IP67 / IP68	IP68
Size	08	14
Contact	4	7
Housing material	Plastic/Metal	Metal

# TECHNICAL DIMENSIONS

## PLUG FLP01

### SIZE 08 – PLASTIC



### SIZE 14 – METAL

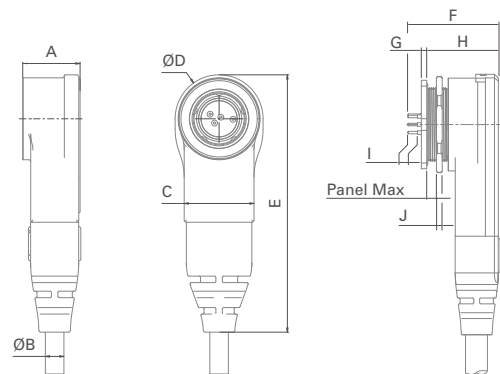

Size	A	ØB	C	ØD	E	Panel Max	F	G	H	I	J	Weight (without cable)
<b>08 Plastic</b>	13.3	4.8	16.2	20.4	59.7	3.0	23.8	2.2	18.9	2.5	2.0	15.8 g
<b>14 Metal</b>	13.0	5.4	15.6	25.4	67.4	3.0	23.4	1.4	18.5	2.5	1.5	44.5 g

Note: Plug is only available pre-cabled with a standard cable length (1m). Contact sales for customized solutions.

# TECHNICAL DIMENSIONS



## RECEPTACLE FLR01

SIZE 08 – PLASTIC

SIZE 08/14 – METAL

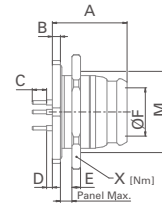
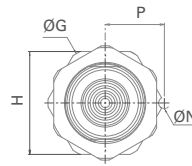

Size 08

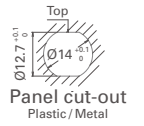

Panel cut-out  
Plastic / Metal

Size 14



Panel cut-out  
Metal

Size	A	B	C	D	Panel Max	E	ØF	ØG	H	M	ØN	P	X	Weight
<b>08 Plastic</b>	13.8	2.2	2.5	0.2	3.0	2.0	8.0	19.9	17.9	M14X0.5	2.0	10.3	1.5-2.0	3.3 g
<b>08 Metal</b>	13.0	1.4	2.5	1.0	3.0	1.5	8.0	19.9	17.9	M14X0.5	2.0	10.3	2.0-4.0	7.5 g
<b>14 Metal</b>	13.0	1.4	2.5	1.0	3.0	1.5	14.0	24.9	22.9	M19X0.5	2.5	12.8	2.0-4.0	15.2 g

## PLUG FLP03

SIZE 08/14 – METAL

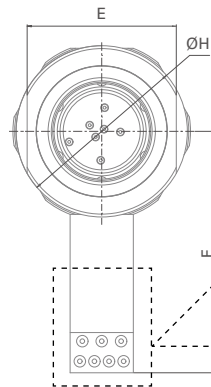
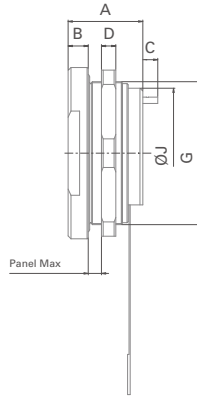

Flex Print ZIF

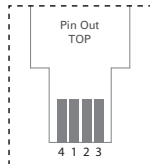

Flex Print Solder

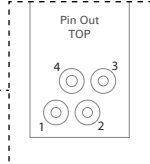

Size 08

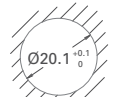

Size 14



Panel cut-out

Size	A	B	C	D	E	Panel Max	F	G	ØH	ØJ	Weight
<b>08 Metal</b>	13.0	3.5	2.7	2.5	21.0	3.7	42.0	M20X0.5	25.0	17.6	20.5 g
<b>14 Metal</b>	13.0	3.5	2.7	2.5	26.0	3.7	42.0	M25X0.5	30.0	22.6	32.6 g

## RECEPTACLE FLR50

SIZE 14 – METAL

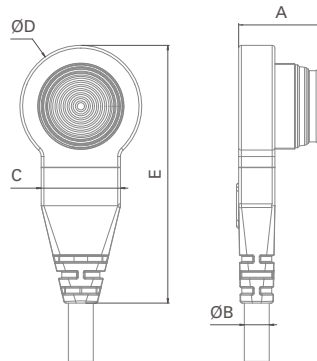

Size	A	ØB Max	C	ØD	E	Weight (without cable)
<b>14 Metal</b>	18.9	5.5	17.5	26.9	56.9	25.0 g

Note: Receptacle is only available pre-cabled with a standard cable length (0.5m). Contact sales for customized solutions.



## MATERIAL & SURFACE FINISH

### SIZE 08 – PLASTIC



- 1 Bend relief – TPE
- 2 Locking – Stainless Steel
- 3 Housing – PEEK Black
- 4 Tracks – Cu Alloy
- 5 Housing – PEEK Black
- 6 Nut – PEEK Black
- 7 Pins – Brass / Gold Plated

### SIZE 14 – METAL



- 1 Bend relief – TPE
- 2 Locking – Stainless Steel
- 3 Housing – Brass Anthracite Nickel
- 4 Tracks – Cu Alloy
- 5 Housing – Stainless Steel
- 6 Nut – Brass Anthracite Nickel
- 7 Pins – Brass / Gold Plated
- 8 Housing – Aluminum Anthracite Nickel

## ENVIRONMENTAL, MECHANICAL & ELECTRICAL DATA

Characteristic	Size 08 – Plastic	Size 14 – Metal	Standard
	Performance	Performance	
<b>Sealing</b> Mated condition/with cap Plug without cap Receptacle without cap	IP67, 0.2m / 30min IP67, 0.2m / 30min IP67, 0.2m / 30min	IP68, 20m / 24h IP67, 0.2m / 30min IP68, 20m / 24h	IEC 60529, MIL-STD-810 Method 512.6
<b>Operating temperature range</b> (connectors only)	-40°C to +85°C	-55°C to +135°C	MIL-STD-810 Method 501.6 and 502.6
<b>Corrosion resistance mated</b>	Salt mist 1,000h Connectors in mated condition.	Salt mist 1,000h <sup>1)</sup> Connectors in mated condition.	MIL-STD-810 Method 509.6
<b>Mechanical endurance</b>	5,000 mating cycles/ 2,500 rotations <sup>2)</sup>	10,000 mating cycles/ 5,000 rotations <sup>2)</sup>	IEC 60512-9-1
<b>Random vibration</b>	9.26G rms	9.26G rms	MIL-STD-202 Method 214 Condition I
<b>Unmating force</b>	Typical 24N	Typical 40N	IEC 60512-13-1
<b>Shock</b>	30 G	30 G	MIL-STD-202 Method 213 Condition J
<b>Max. current rating</b>	2x 5A power and 2x 1A signal	3x 5A power and 4x 1A signal	IEC 60512-5-2-5b
<b>Max. wire size</b>	Up to 24AWG	Up to 24AWG	-
<b>Data protocols</b>	USB2.0 and Ethernet	USB2.0 and Ethernet	-

<sup>1)</sup> Exception: 48h for FLR50

<sup>2)</sup> 180° rotation considered per mating within the mating cycle test

## ACCESSORIES

- Soft caps
- Straight bend relief



## ACTIVE DEVICES



For more information visit  
[fischerconnectors.com/lp360](http://fischerconnectors.com/lp360)